



Min·A·Kit Book

Now YOU CAN
PLAN YOUR KITCHEN

THE *Youngstown* WAY

YOUNGSTOWN Wall and Base Cabinets are all steel construction with Hi-Bake enamel finish. Doors and drawer heads are insulated and, also, equipped with rubber discs for quiet closing.

Handles are chrome finish.



Sizes:
18" x 18" x 13"
21" x 18" x 13"
24" x 18" x 13"
36" x 18" x 13"



Size: 15" x 30" x 13"
One door with either right or left-hand hinges.



Sizes:
18" x 30" x 13" 27" x 30" x 13"
21" x 30" x 13" 30" x 30" x 13"
24" x 30" x 13" 36" x 30" x 13"



Corner Wall Cabinet
Size: 25" x 30" x 25"



YOUNGSTOWN
Broom and Linen Cabinets
Size: 21" x 84" x 13"



Base Corner Filler
Size: 25" x 36" x 25"



Base Drawer Cabinet
Sizes: 15" x 36" x 24"
21" x 36" x 24"
27" x 36" x 24"



Sizes: 15" x 36" x 24"
18" x 36" x 24"
One door with either right or left-hand hinges.



Sizes: 21" x 36" x 24"
24" x 36" x 24"
27" x 36" x 24"
30" x 36" x 24"
36" x 36" x 24"



It is Easy to Modernize Your Kitchen

... BY THE YOUNGSTOWN "MIN-A-KIT" METHOD OF KITCHEN PLANNING

WOMEN of America have created standards of living, finest in the world. Their personality, taste and ingenuity are expressed in their homes. Their ideas for making work easier have guided Science and Industry in producing modern materials, equipment, and conveniences available today. Widespread feminine appreciation and purchase of work-saving items have created such a demand that manufacturers are producing them in large quantities and at reasonable prices so the great mass of American people can enjoy them.

Modern kitchen appliances are an outstanding illustration of Industry's cooperation with women's thinking along work-saving lines. But, all too often, the convenient toasters, mixers, and coffee makers have been relegated to some out-of-the-way place where lack of storage space or lack of work surface make it impossible to keep them instantly ready for use.

Here, the Youngstown Kitchen, designed and built by Mullins Manufacturing Corporation enters the picture.



Modern Equipment For Your Comfort

Mullins' engineers have made many contributions to better living through their work in the automobile and home appliance fields. Their achievements are reflected in the style, durability and price of hundreds of items in every day use by American women.

In the kitchen too, Mullins designing has made great changes. Today, Youngstown Kitchens by Mullins are produced on assembly lines so that anyone can own a modern, durable kitchen at surprisingly low cost.



To make these modern kitchens really efficient, Mullins goes beyond the blue print and the laboratory. Field investigators go to housewives themselves for ideas of practicality under actual working conditions. Even in the matter of kitchen planning, they consulted housewives, for they realized that no one else knows quite so well what is needed and how it should be arranged.

Cut on dotted line. Fold on light line. Insert tabs B into slots A. Tabs C fasten the wall cabinets to the Min-A-Kit walls and should be inserted into the dotted line X-Y on the walls. Fold the Kirchneraider backsplash between the two heavy black lines.

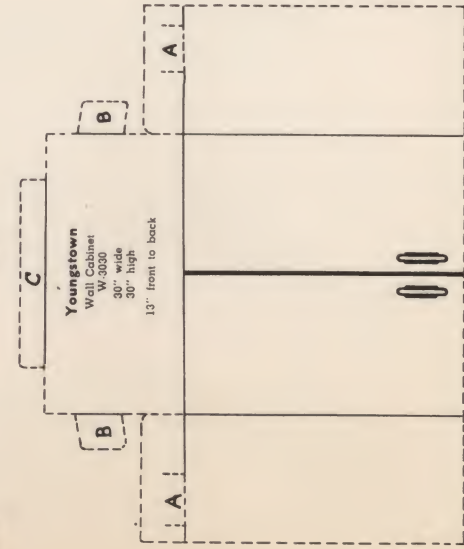
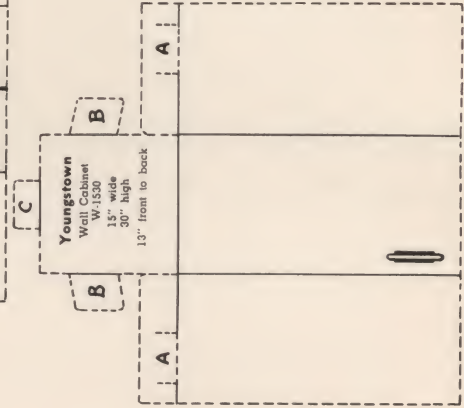
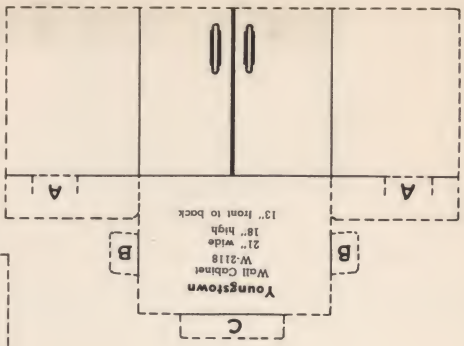
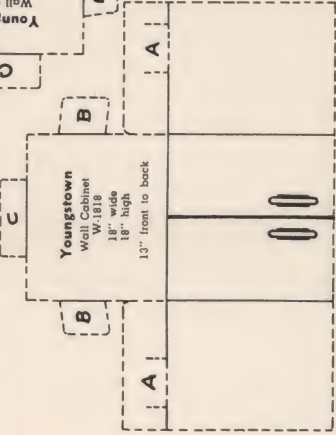
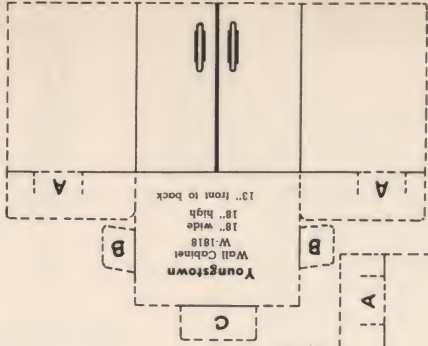
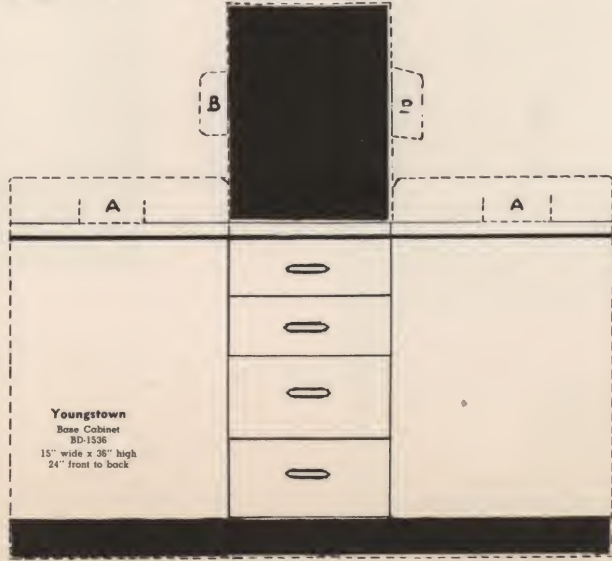
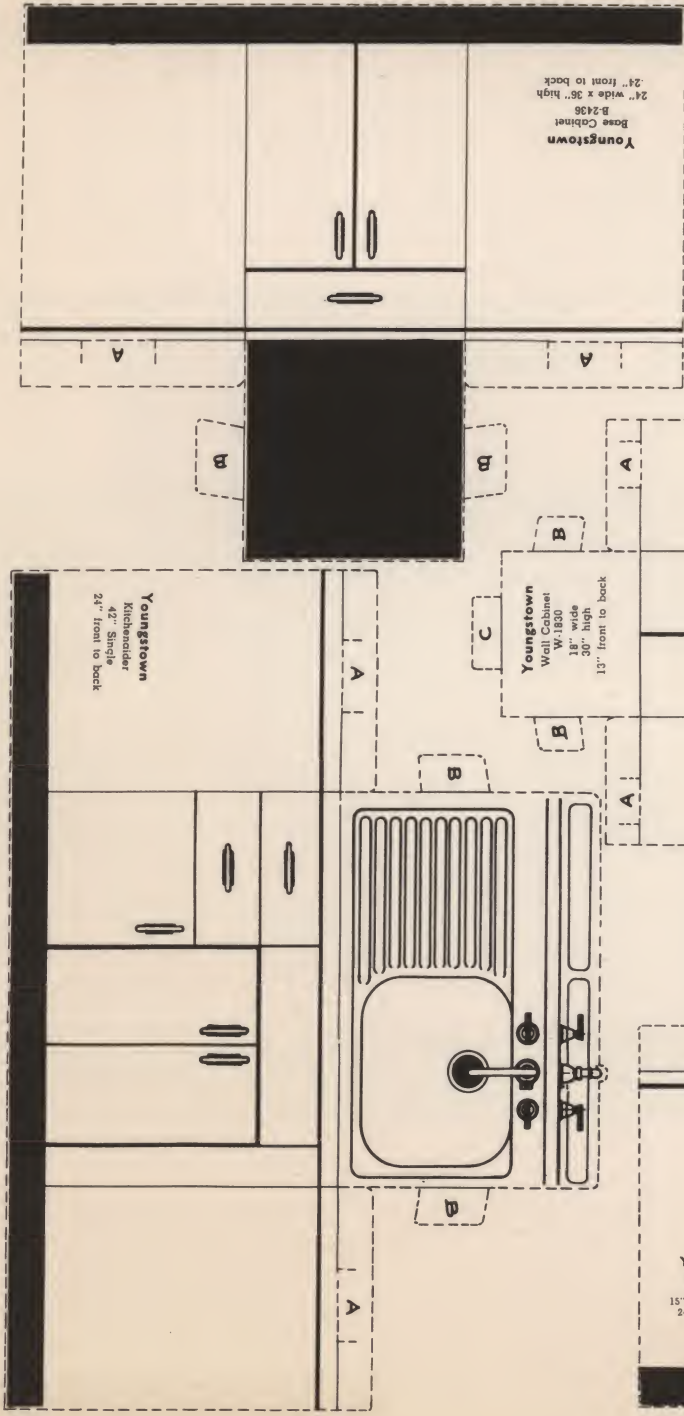

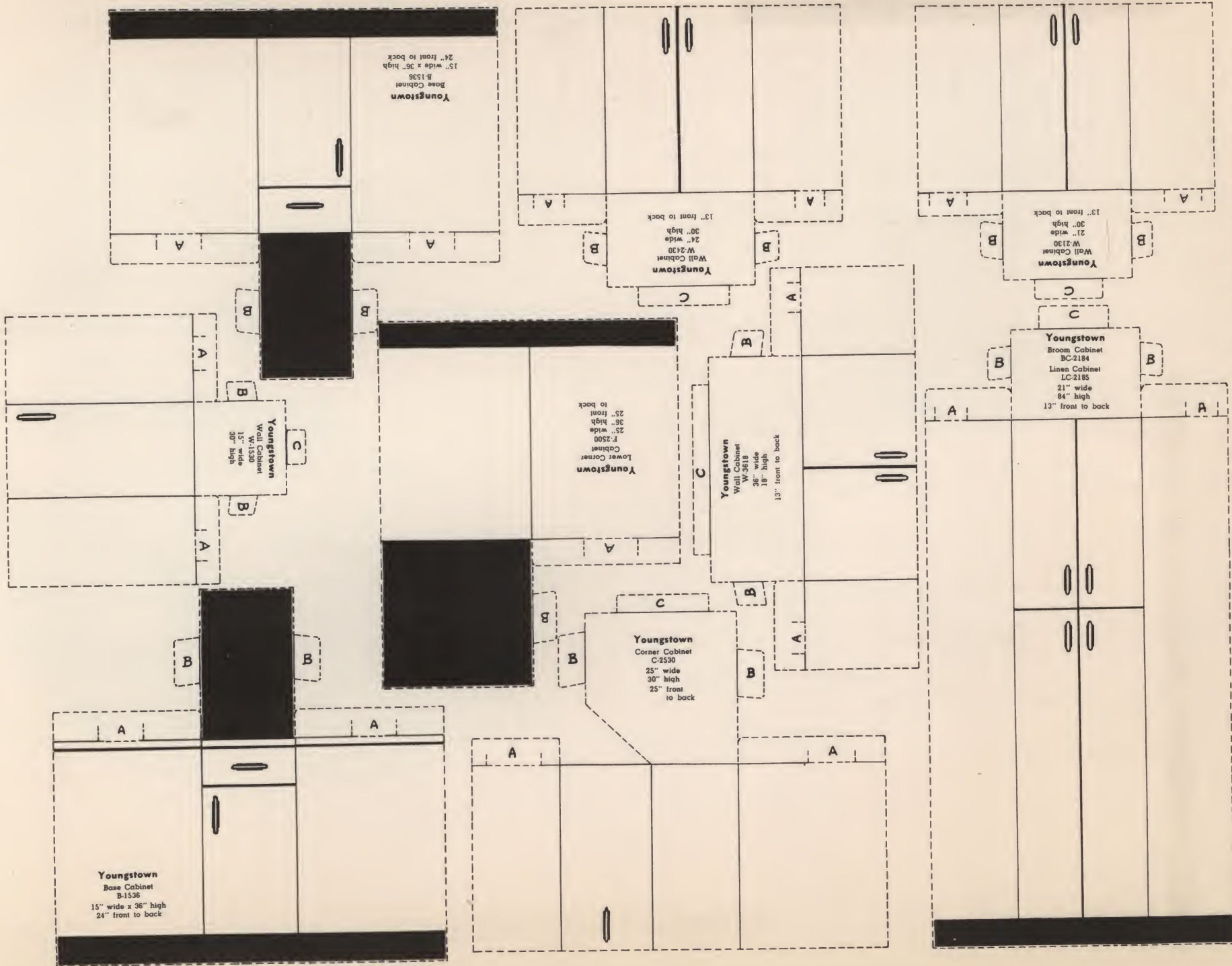

Cut on dotted line. Fold on light line. Insert tabs B into slots A. Tabs C fasten the wall cabinets to the Min-A-Kit walls and should be inserted into the dotted line X-Y on the walls. Fold the Kitchenaid backplash between the two heavy black lines.

I

N this book, we have assembled the necessary factors to make it easy, pleasant and profitable for you to plan your own kitchen. If you wish to modernize or to arrange a "dream kitchen" for your new home, you'll find this booklet helpful.

Forty-four easy-to-cut-out models of YOUNGSTOWN Cabinets and Kitchenaiders, plus stove and refrigerator cut-outs and two kitchen walls, give you the material for an infinite number of arrangements so that you can choose the one most perfectly suited to your needs. With Youngstown's matching steel equipment you'll have the beautiful kitchen you've always wished for.

Instructions for Use of Min-A-Kit

1. The inside front and back covers of this book are to be used as the walls of your model kitchen. Remove the covers in one piece by opening the staples in the back.
2. Select a cardboard box $11\frac{1}{2}'' \times 11\frac{1}{2}''$, or larger, and cut down the two adjoining sides to $3\frac{3}{4}''$ high.
3. Paste the covers of the book to the sides of the box with crease of covers fitted into the corner of the box.
4. If you wish the three wall, or U-shaped kitchen, a third wall can be added easily by using a sheet of cardboard, or heavy paper, cut to size and glued into place.
5. Prepare cut-outs by cutting on the dotted line. Fold on light line. Insert tabs B into slots A. Tabs C fasten the Wall Cabinets to the Min-A-Kit walls and should be inserted into slots cut into the dotted line X-Y on the

wall. Fold the Kitchenaid splashback between the two heavy black lines.

When you have decided where you want to place a wall cabinet, cut a slot in the dotted line X-Y large enough to insert tab C. This method will give a stronger wall and hold the wall cabinets in line better.

6. SCALE—One inch of Min-A-Kit wall length equals 21 inches of actual kitchen wall length. For example, if one of your kitchen walls is eight feet, three inches long, you would arrive at the Min-A-Kit length by:

$$8'' \times 12'' + 3'' = 99'' \text{ actual length of kitchen wall}$$
$$99'' \div 21'' = 4\frac{5}{7}'' \text{ length of Min-A-Kit wall } (4\frac{3}{4}'')$$

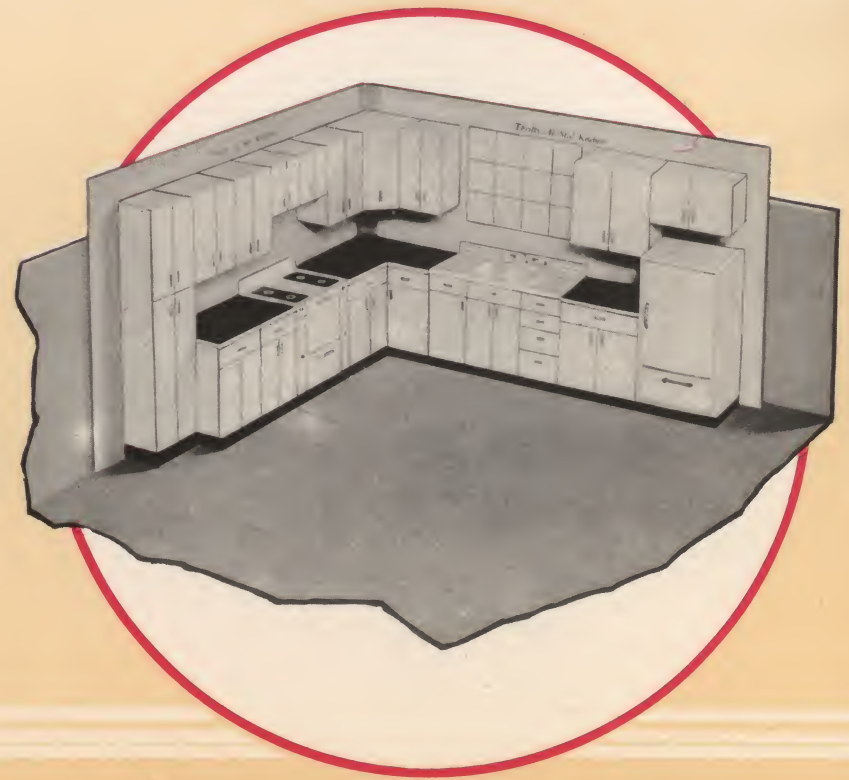

Measuring the Kitchen



in the so-called ideal arrangements increases the cost of installation, due to changing water lines, waste lines, etc., to a point where the cost is out of line with the results obtained.

3. In the kitchen illustrated, which we are using as an example of how to plan your kitchen, one wall is 146" long; the other, 100".

4. On the 146" wall, which will give us a window over the Kitchenaid, let us try the range and a Corner Filler to give a continuous work surface for both the 146" and the 100" wall.

| | |
|-------------------------|--------------------------------------|
| Length of wall | 146" |
| Length of Corner Filler | 25" |
| | <hr style="width: 50%; margin: 0;"/> |
| | 121" |
| Length of Kitchenaid | 66" |
| | <hr style="width: 50%; margin: 0;"/> |
| | 55" |
| Length of range | 39" |
| | <hr style="width: 50%; margin: 0;"/> |
| | 16" |

The nearest base cabinet to the size of wall space remaining (16") is the 15" Base Cabinet, which fits very comfortably into the space. (See inside covers.)

This cabinet can be placed either between the Kitchenaid and the range, or between the range and dining room door.

On this wall, two wall cabinets, 18" high, can be used over the range. If the 21" width and 18" width are used, they will exactly fill the wall space above the range.

A wall cabinet 15" wide and 30" high will fit perfectly above the 15" Base Cabinet.

5. For the 100" wall, where the refrigerator is to be placed:

| | |
|---|--------------------------------------|
| Length of wall | 100" |
| Length of Corner Filler | 25" |
| | <hr style="width: 50%; margin: 0;"/> |
| | 75" |
| Length of refrigerator (Allowing 3" for free air circulation) | 36" |
| | <hr style="width: 50%; margin: 0;"/> |
| | 39" |



Now, we are ready to plan for base and wall Cabinets.

The remaining 39" can be filled either, by putting a 21" width and an 18" width Base Cabinet next to the Corner Filler and placing the refrigerator at the end, or (see illustration) by putting an 18" width Base Cabinet between the Corner Filler and the refrigerator and a 21" width Broom Cabinet at the end.

For wall cabinets, we have used the Corner Wall Cabinet above the Corner Filler, an 18" width Cabinet above the 18" width Base Cabinet and two cabinets, 18" width and 18" height, above the refrigerator.



Whether your kitchen is a new one or one to be remodeled the effect is the same—a beautiful modern kitchen that fits its surroundings perfectly. 7

IN USING the Min-A-Kit to plan your new, or remodeled, kitchen follow these easy steps:

1. Using the scale of one inch on the Min-A-Kit wall for 21" of actual kitchen wall space, draw in, on the Min-A-Kit wall, the size and location of windows and doors in your kitchen. If you have any other unusable space, such as chimney corners or wall offsets, indicate these on the Min-A-Kit wall, also. This leaves the rest of the wall space free so that you can plan how to place cabinets, Kitchenaid, range and refrigerator to best advantage.

2. Determine on what wall you want to place the sink, range, and refrigerator. Home Economists say the range should be near the dining room door and the refrigerator near the outside door, with the sink unit placed between. However, there is no hard and fast rule on these locations. We believe that each individual housewife must plan her kitchen for her own convenience. Many times, locating the units

Cut on dotted line. Fold on light line. Insert tabs B into slots A. Tabs C fasten the wall cabinets to the Min-A-Kit walls and should be inserted into the dotted line X-Y on the walls. Fold the Kitchenaid backsplash between the two heavy black lines.

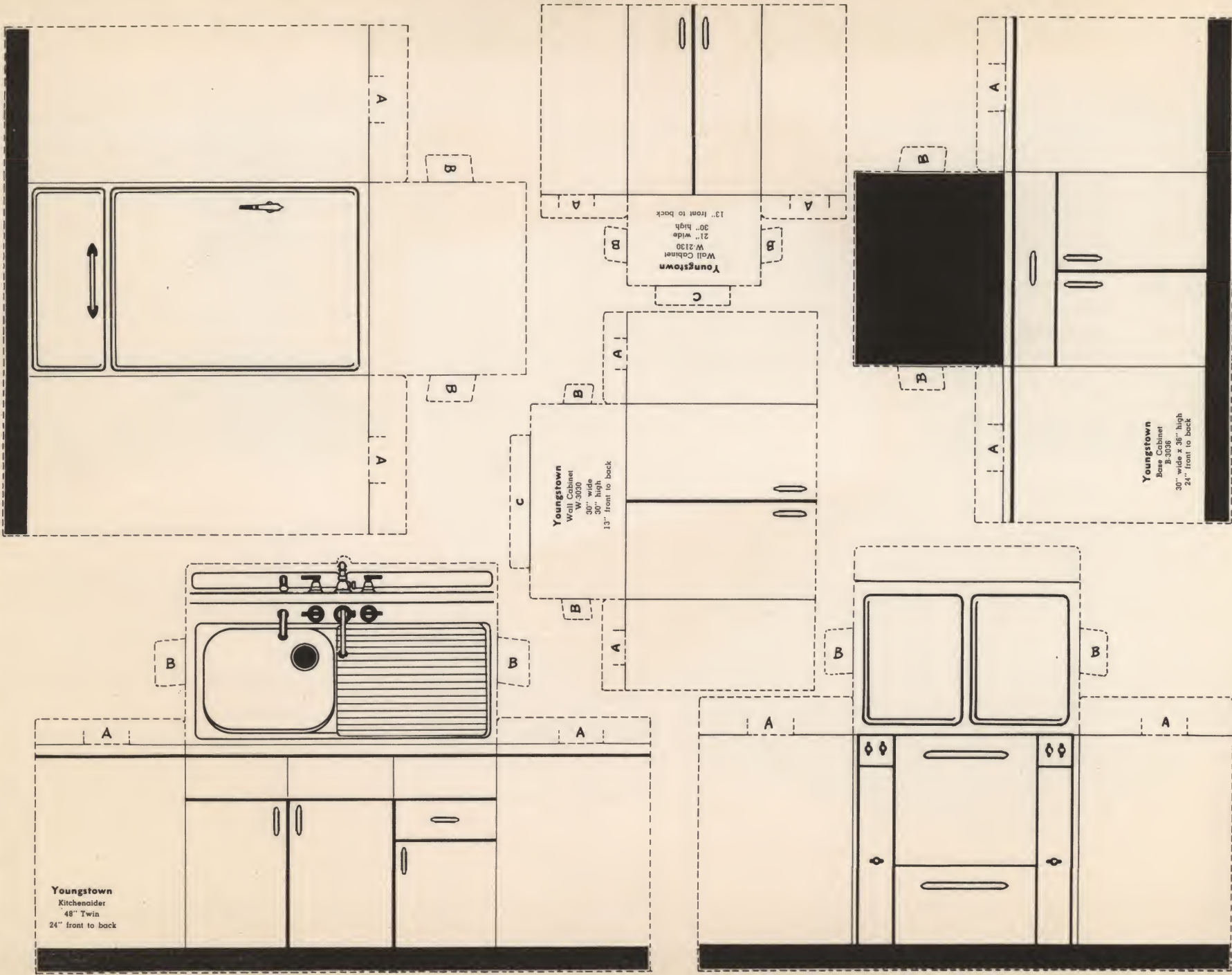

The Heart of a Planned Kitchen

THE heart of the modern kitchen is the YOUNGSTOWN Kitchenaider (to replace the old-fashioned sink). This is the most constantly used center in the kitchen and, therefore, should be a model of convenience.

Even if the housewife is not planning to modernize her kitchen at the present time, she should use the YOUNGSTOWN Min-A-Kit Planning Method in selecting and locating her YOUNGSTOWN Kitchenaider, so that she can complete the modernization of her kitchen later according to a definite pre-arranged plan.

YOUNGSTOWN KITCHENAIDERS

All YOUNGSTOWN Kitchenaiders are 36" high from the floor to the top of the sink and 24" from front to back. Splashbacks are four inches high. There are four widths: 42" (three models), 48", 54" (two models), 66". This range of widths gives the planner a wide variety of kitchen arrangements.

UNIT CONSTRUCTION

The basis of the ease with which a YOUNGSTOWN Kitchen may be planned around a YOUNGSTOWN Kitchenaider is the wide range of standard Base Cabinet sizes. The standard Base Cabinet widths are 15", 18", 21", 24", 27", 30", and 36". (See inside covers of Min-A-Kit Book or Youngstown catalog, *Get Acquainted with your Kitchen.*)



There are a sufficient number of sizes and combinations of sizes to meet almost every need and in-between sizes can be obtained when necessary.

BASE and WALL CABINETS

Youngstown Base Cabinets are 36" high and 24" from front to back. Cabinet tops

are a heavy grade of gray linoleum, with or without coved four-inch splashback. Tops may be unit or continuous style.

YOUNGSTOWN Wall Cabinets are all 13" from front to back and come in two heights:

The 30" height comes in the same widths as the Base Cabinets, so that

every Base Cabinet may have the same size of Wall Cabinet over it when wall space permits.

The 18" height comes in 18", 21", 24" and 36" widths. They are usually placed over ranges, refrigerators, or Kitchenaiders, so these sizes, or combinations of sizes, fit practically every situation.

BROOM and LINEN CABINETS

Both Broom and Linen Cabinets are 21" wide, 84" high, and 13" deep. The tops of the Wall Cabinets are lined up with the tops of the Broom and Linen Cabinets. This leaves 18" between Base and Wall Cabinets—a comfortable distance for one working on the counter top.

CORNER CABINETS

To take advantage of space that might otherwise be wasted, Mullins has produced two unique corner cabinets.

The Tilt-Top Corner Base Cabinet . . .

This matches the other base cabinets, but since it is placed in the corner, it can have no doors or drawers. However, the top has been made so that it will lift up and thus permit the use of this large storage space for sacks of flour, sugar, meal, etc., or even for little-used or over-sized utensils.

The Corner Wall Cabinet . . .

This cabinet has astonishing storage capacity. It holds as many as 170 dishes without crowding.

Youngstown Kitchenaiders—to replace the old fashioned sink

Youngstown Kitchens, THA

Easy to Plan—

WHEN the colorful kitchens you see homemakers who now enjoy them decide the Youngstown Min-A-Kitchen method cabinets close to the Kitchenaid because your individual kitchen needs can be why more women prefer to plan with Youngstown each kitchen unit you can make provisions where they are needed, rather than try to fit what was never intended to fulfill your personal

Start with Kitchenaid

Remember the Youngstown Plan follows the one shown here. First they chose a particular Kitchenaid to replace their old-fashioned sink. They chose 66, 72, 84 and 96 inches . . . no other models and features. To the Kitchenaid they added the cabinets needed to complete facilities at the counter surface and storage space. This arrangement and refrigerator offers you new benefits. No alteration or blue prints are needed. Arranging

1. Here is a good example of a YOUNGSTOWN Kitchen that is started with a Kitchenaid 66" Twin and three Wall Cabinets. This housewife has discovered that storage space, working surface, and arrangement of utensils for on-the-spot use make kitchen comfort.

2. In this YOUNGSTOWN Kitchen, the Kitchenaid 66" Twin has been used, with continuous linoleum top covered against the wall. This is an unusually high back. Four inch heights are recommended.

3. Here is the Kitchenaid 66" Twin with the porcelain enamel top, double drainboards, and four inch splashback. Notice, also, the Wall Cabinet with angle shelf, to accommodate taller-than-usual articles.



Housewives HAVE PLANNED!

Here's Why . . .

ere were still in the "dream" stage, the
d to test their ideas of arrangement by
. They arranged counter tops and wall
e most kitchen tasks start at this point.

met as you plan in miniature. That's
ungstown. With the little replicas of
n for storage and preparation facilities
fit your kitchen to a blue print that
al need.

wed by homemakers whose kitchens are
r model of the Youngstown Kitchen-
These may be had in sizes 42, 48, 54,
nufacturer offers so complete an array
ider you add the base cabinets and wall
he point you know requires more work
ment in conjunction with your present
auty and efficiency . . . no expensive
one can plan the Min-A-Kit way.

4. and 5. Here, again, the housewife has made a very efficient kitchen and, yet, her arrangement is quite different from the other installations.

She has chosen the YOUNGSTOWN Kitchenaider 54" Deluxe with double drainboards and five utility drawers. Notice her use of Corner Wall Cabinets. In each of these cabinets she can easily put 160 ordinary sized dishes.

6. In this remodeled kitchen, notice how much working surface and storage space the housewife has provided herself by choosing the YOUNGSTOWN Kitchenaider 66" Twin and Base Cabinets. There is also plenty of room for a good sized table.

The open Wall Cabinet shows how many dishes can be neatly arranged in YOUNGSTOWN Cabinets.



Some of the Conveniences offered in *Youngstown Kitchens*



1

1 Utility cabinet for storage of linens, staples, oversized utensils, or other equipment.

2 Utility cabinet for cleaning equipment with two shelves for general use.

3 Sliding, removable container with sifter outlet for flour or sugar.

4 Removable wooden cutting board that is sturdy enough to serve as holder for food grinder. Floating shelf of enameled steel for articles such as electric mixer.

5 Cut-away view of drawer front showing how drawers and doors are heavily insulated for quietness.

6 Cut-away view of sliding drainboard on Kitchenaid 48" Twin. Drainboard can be removed entirely while washing dishes. Rinse with steaming hot water then cover with drainboard for sanitary, easy dish-drying.

7 Cutlery drawer in Kitchenaiders and Base Cabinets lined with best grade black linoleum—partitioned with enameled steel dividers.

8 Wall cabinets with angle shelf to accommodate higher-than-usual articles. Size of cabinet 36" x 18" and 36" x 30".



2

8



7

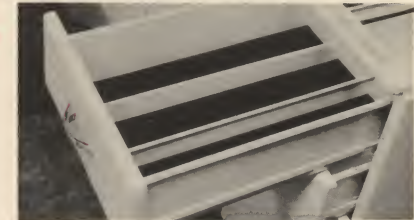

6

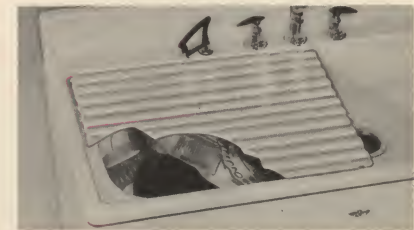

5



3



4

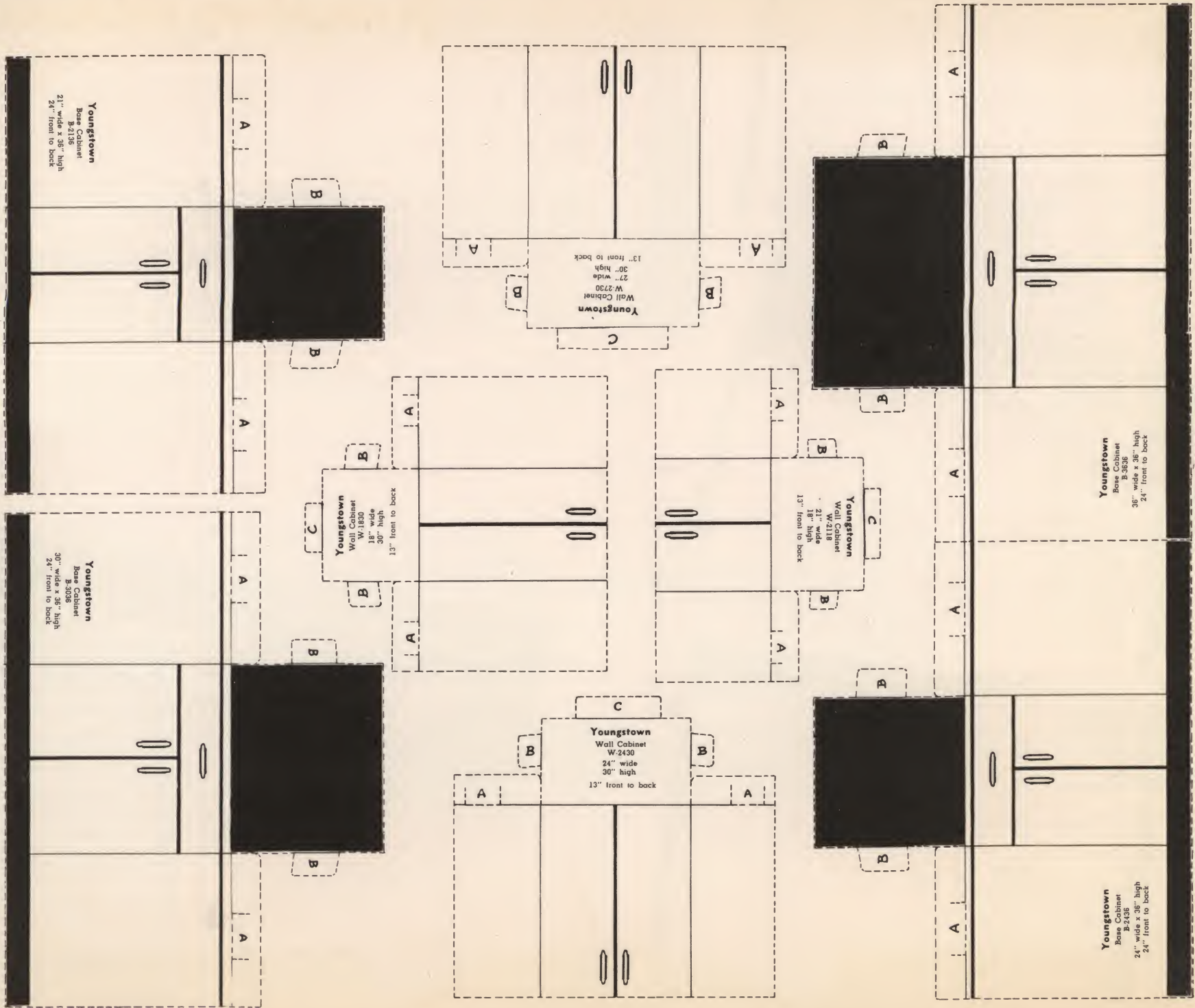

Cut on dotted line. Fold on light line. Insert tabs B into slots A. Tabs C fasten the wall cabinets to the Min-A-Kit walls and should be inserted into the dotted line X-Y on the walls. Fold the Kitchenaid backsplash between the two heavy black lines.

Kitchenaider Tops

For beauty, durability and sanitation, Mullins recommends and features its own perfected porcelain enameled Kitchenaider tops. They are acid-resisting, durable, and, being non-porous, will not harbor germs. No substitute has ever been developed for this glistening, pearl white, easily cleaned feature of the modern kitchen.

It is the first thing that catches the eye in a brand new kitchen. As proof of the popularity of porcelain enamel sinks, over 1,500,000 were sold in 1942 for both old and new homes.

Occasionally, however, a housewife prefers to have a linoleum sink top with a porcelain enamel bowl fitted into it.

Mullins has developed a special sink bowl, a linoleum covered steel top, and a method of assembling them which is far superior to anything yet developed.

On special order, a linoleum sink top may be built, continuous with the tops of adjacent base cabinets, but the expense of this special type of top rarely can be justified when you see the neat appearance of standard tops sealed with the new metal insert that both locks and seals.



KITCHENAIDER 42" Twin, acid-resisting porcelain enamel top.

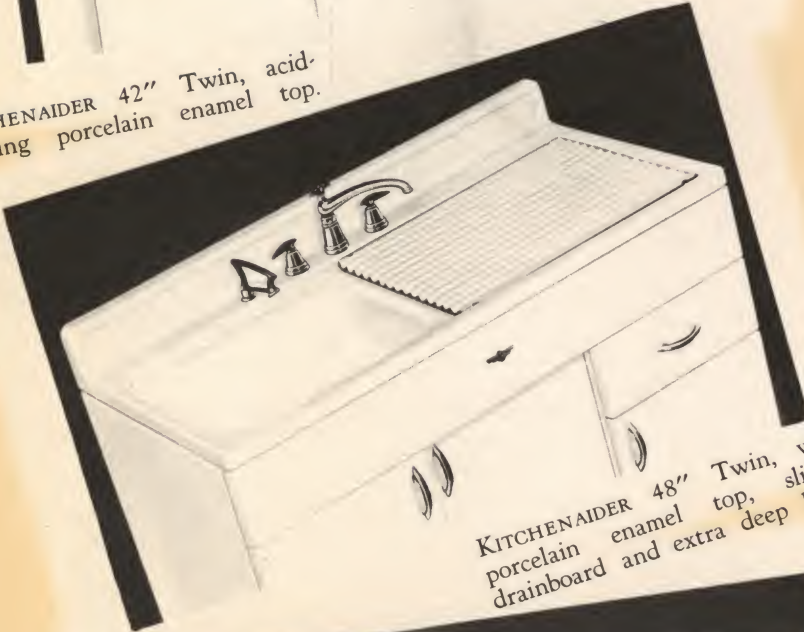

KITCHENAIDER 48" Twin, with porcelain enamel top, sliding drainboard and extra deep bowl.



KITCHENAIDER 54" Single Bowl with porcelain enamel top.



Linoleum Sink Top with Double Bowl.

Your Choice . . . Space or Fillers

BECAUSE many kitchens have odd dimensions, the kitchen planner will sometimes have left-over space too small for an extra cabinet. Here are some suggestions for using this space:

If the space is at least three inches wide, a towel rack can be attached to the end of the cabinet to provide an out-of-view place for hanging tea or hand towels. Many housewives use the space for ironing boards, mops, brooms, etc.

If a wall-to-wall arrangement is desired, standard wall, base and top fillers (as illustrated) may be obtained in any width up to three inches.

This Drawer Cabinet comes in three sizes and has such a variety of uses that it can be used to advantage next to the Kitchenaid or the range to hold linens, cutlery, cooking utensils, staple groceries, trivets, paper supplies, etc. The lower drawer is large enough to hold a metal bread or cake box.

Sizes:

Widths - 15", 21", 27"
Height - 36"; Depth - 24"

Base Corner Filler

For either an L-shaped or U-shaped kitchen, where you do not wish to go to the extra expense of a special continuous top, the Base Corner Filler is used to give some work surface.



Towel Rack

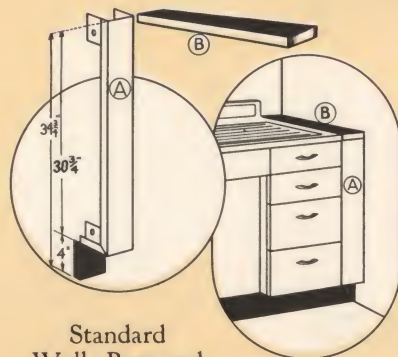

Standard
Wall, Base and
Top Filler



Base Corner Filler

Standard "Youngstown" Accessories . . .

INCLUDED in the Youngstown standard catalog listings, are the following popular accessory items:

A Metal Bread Box which fits into the large drawer of the 54" Kitchenaid Deluxe, 66" Kitchenaid Twin, or the Base Drawer Cabinet. This clears the counter space usually taken up by the old-fashioned bread box.

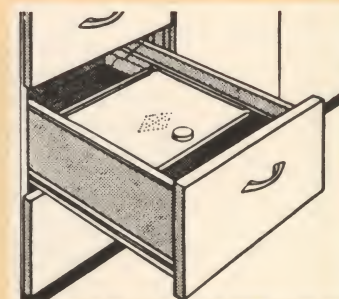

What-Not Shelves in pairs, on each side of the window or at the end of a line of wall cabinets, help to bring beauty into the kitchen by holding colorful pottery, small plants, herb or spice jars, etc.



A Flour Sifter which fits the wall cabinets in either the 18" or 30" height. This item is very convenient. The sifter, mounted on an extension shelf, slides out with ease. Capacity, 23 lbs.

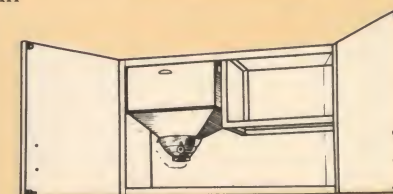

Soffits

THE soffit, or valence, is a panel extending from the top of the wall cabinets to the ceiling. For the soffit, various materials may be used. The material most generally used in remodeling is standard wallboard.



Base Drawer
Cabinet

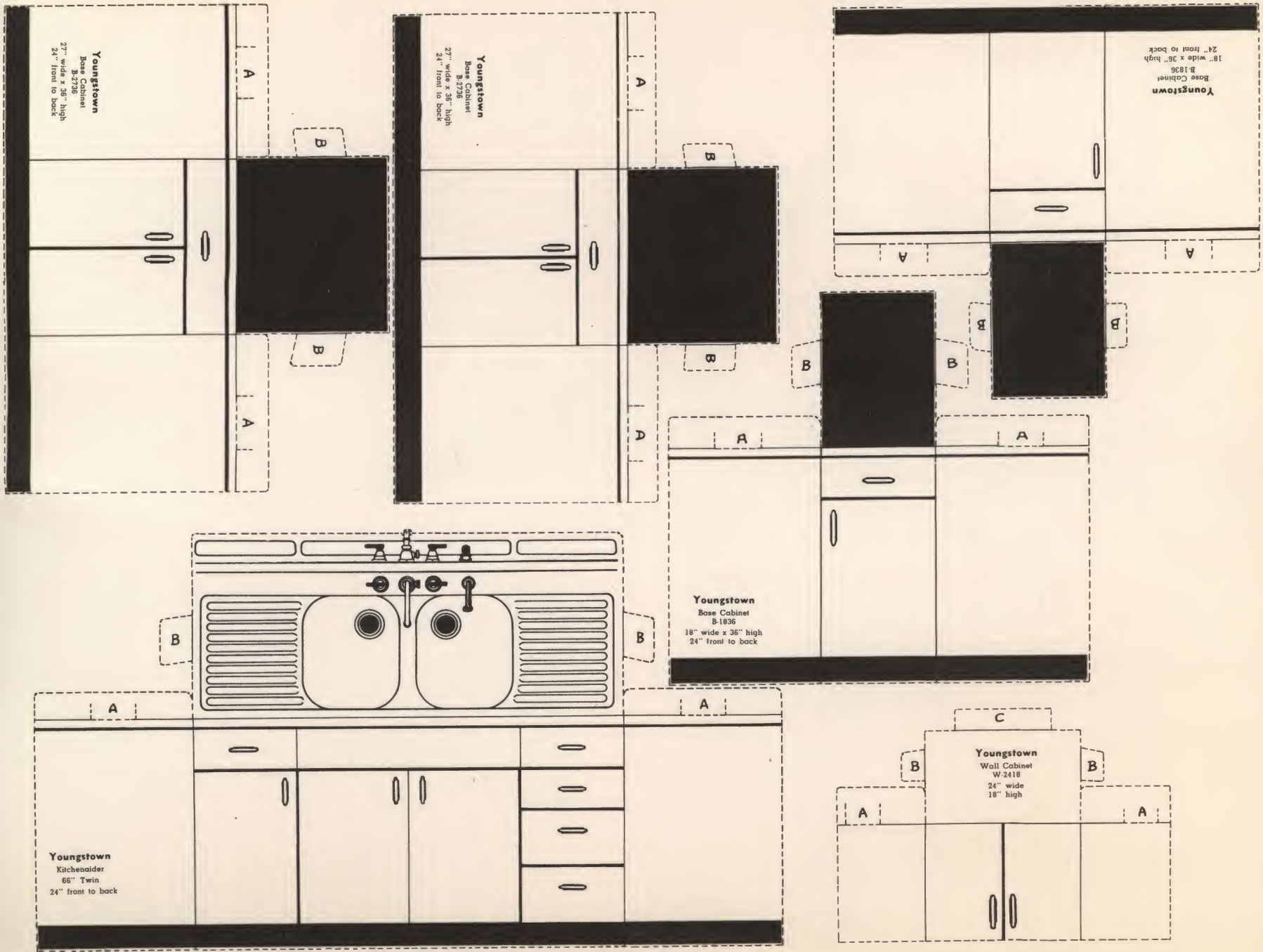

Cut on dotted line. Fold on light line. Insert tabs B into slots A. Tabs C fasten the wall cabinets to the Min-A-Kit walls and should be inserted into the dotted line X-Y on the walls. Fold the Kitchenaid backsplash between the two heavy black lines.

MIN·A·KIT
Planned
KITCHENS
Save
TIME & MONEY

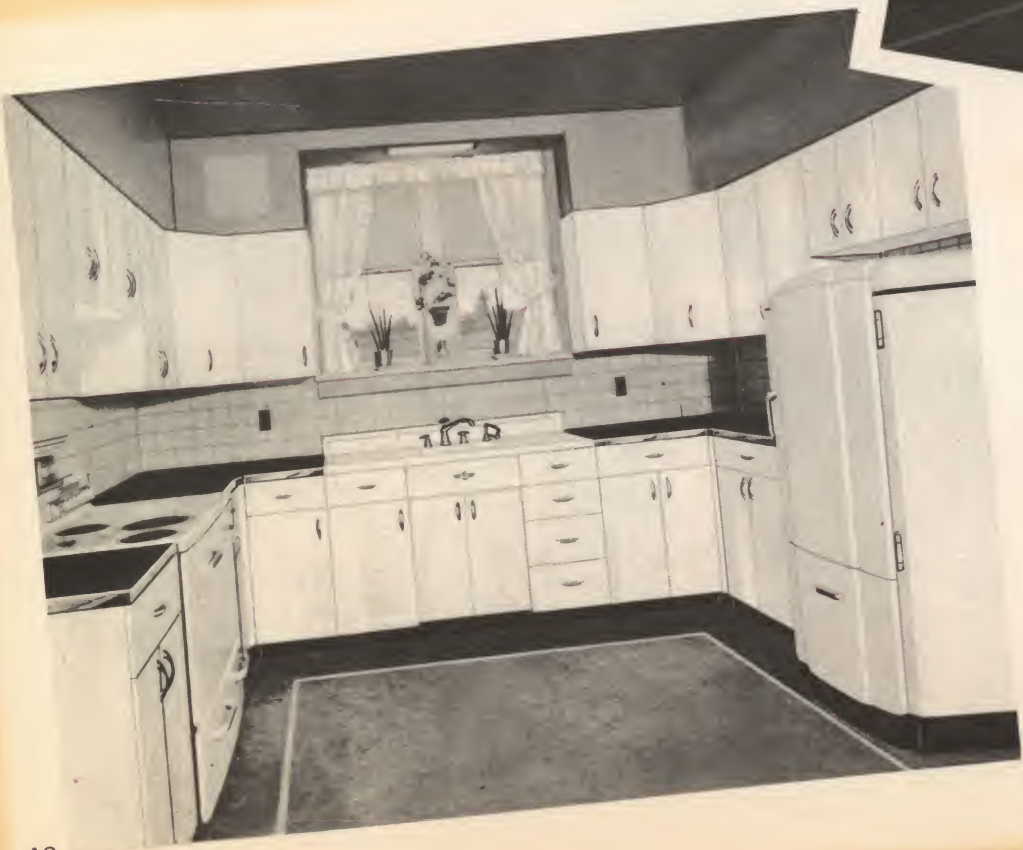

The Youngstown Kitchenaid Line . . .



KITCHENAIDER 66" TWIN
Width: 66"



KITCHENAIDER
54" DeLuxe
Width: 54"



KITCHENAIDER
54" STANDARD
Width: 54"



KITCHENAIDER 48" TWIN
Width: 48"
Deep bowl on left



KITCHENAIDER
42" TWIN
Width: 42"
This model comes
with deep bowl on
either right or left-
hand side, as pre-
ferred.



KITCHENAIDER
42" DeLuxe
Width: 42"
This model comes with
either right or left-hand
drainboard, as preferred.



You can have a modern
Youngstown Kitchen
for the price of a
good refrigerator.

Easy to plan . . . quickly installed,
beautiful in gleaming enameled
steel. Yours to enjoy for a lifetime.



 *Youngstown Kitchens*
by *Mullins*

Digitized by



ASSOCIATION
FOR
PRESERVATION
TECHNOLOGY,
INTERNATIONAL
www.apti.org

BUILDING
TECHNOLOGY
HERITAGE
LIBRARY

<https://archive.org/details/buildingtechnologyheritagelibrary>

From the collection of:

Mike Jackson, FAIA

You can have a modern
Youngstown Kitchen
for the price of a
good refrigerator.

Easy to plan . . . quickly installed,
beautiful in gleaming enameled
steel. Yours to enjoy for a lifetime.



Youngstown Kitchens
by *Mullins*